

## Preparation

- 1 Pergo domestic Elegance is delivered with instructions in the form of illustrations. The texts below provide explanations for the illustrations, and are divided in three areas: Preparation, Installation and Cleaning instructions. We recommend that you read through this information carefully while studying each illustration. In case of doubts or questions please contact your dealer or technical services. The use of the original Pergo accessories is strongly recommended to benefit from the full Pergo warranty.

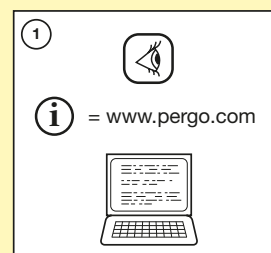

- 2 Pergo domestic Elegance can be bought in different decors. Make sure you have received the flooring that you ordered before starting the installation. It is always a good idea to store one end label together with your receipt.

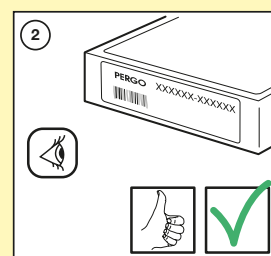

- 3 After receiving the floor packs these should be acclimatized, unopened and stored in a flat position free from the wall and flooring prior to installation. We recommend storing them at normal room temperature (between 15-20 degrees C / 59-68 degrees F) and a relative humidity (RH) between 30 – 75% for a minimum of 48 hours prior to installation.

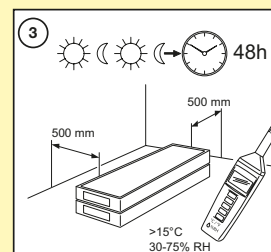

- 4 Pergo domestic Elegance must be installed on a solid, self-supporting subfloor, wood flooring or floors covered with seamless, undamaged vinyl. In case of textile floor coverings, however, both the textile flooring and the eventual underlayment must be removed.

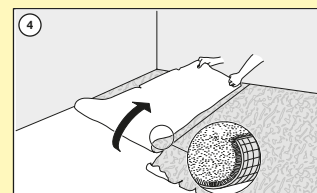

# domestic **Elegance**

## Preparation

- 5 The entire subfloor must be carefully checked for any unevenness. Using a 1 m straight edge, make sure there are no unevenness of more than 2mm. Also make sure there are no “peaks” higher than 1.2mm within a 250mm radius. In case of sand or grind peaks, use self-leveling compound as needed to achieve correct flatness. Let this cure and dry before installation. Ask your dealer for advice.

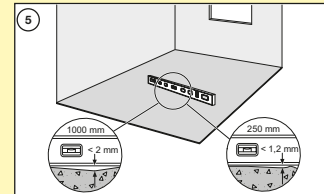

- 6 After checking the subfloor for unevenness, carefully vacuum the entire surface. To avoid risk of squeaking, secure any loose particleboard, OSB, fiberboard, timber planks etc. with screws.

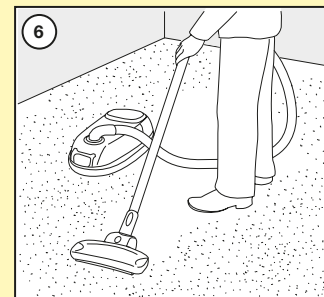

- 7 To achieve optimal sound protection, best possible walking comfort, to avoid squeaking in joints and to level minor unevenness in the subfloor an appropriate Pergo underlayment is strongly recommended. Ask your dealer for advice. If other than Pergo underlays are used or if the chosen Pergo underlay does not have a vapour barrier, a 0,2mm PE-film has to be installed as a minimum damp protection if such is needed (see ill.11). The PE-film must be overlapping in the seams at least 200mm.

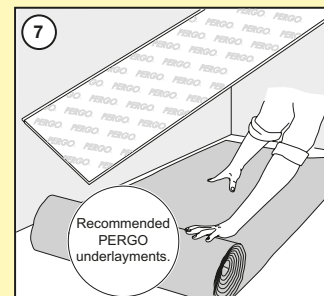

- 8 Pergo domestic Elegance must not be installed in a typical wet room or in rooms with a floor drain.

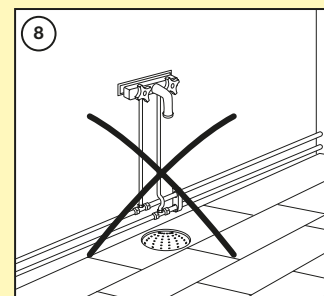

# domestic **Elegance**

## Preparation

- 9 Pergo domestic Elegance is designed to be installed as a floating floor to allow natural expansion and contraction with changes in temperature and humidity. To achieve the benefits of a floating floor and to avoid possible gaps, squeaking etc. never fasten the floor with nail, screws, silicone etc.

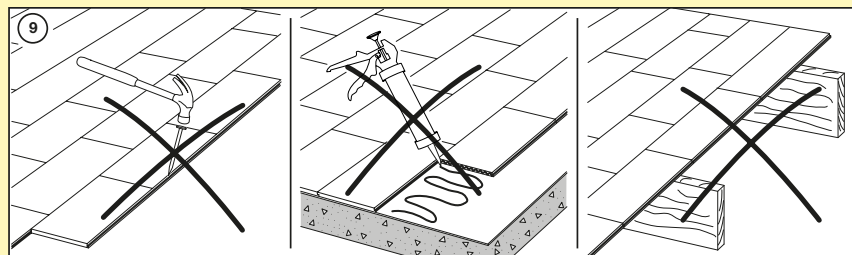

- 10 Mineral subfloors such as concrete must be sufficiently dry prior to installation. (<2,5% CM / 75% Tramex). If the moisture content is higher, or may become higher, other types of damp proofing like Pergo MoisturBloc must be used. Ask your dealer for advice. A vapour barrier must be used when installing Pergo on mineral subfloors regardless the age of the subfloor. Pergo Smart Underlay+ and Pergo Professional SoundBloc have an appropriate vapour barrier built-in. In all other cases, always use a 0,2mm PE-foil under the regular underlayment.

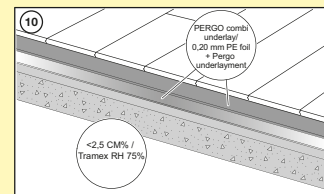

- 11 When installing Pergo domestic Elegance on under floor heating a vapor barrier always must be put down before recommended underlay is installed. We recommend using one of the Pergo underlays which have a vapour barrier included. Your dealer or installer of the underfloor heating system must guarantee that the surface temperature never exceed 28°C .

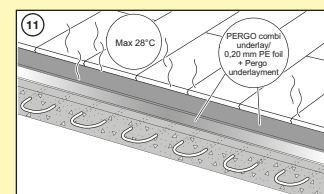

# domestic Elegance

## Preparation

- 12** A Pergo laminate floor is mainly composed of natural wood and will naturally expand and contract upon changes in the relative humidity. The dimensional variation of the installed floor will almost be equal in length and width. At 20°C and a relative humidity, RH, between 40-60%, the movement is minimal. Pergo laminate flooring is produced and delivered with a moisture content to cope with a RH between 30-60%. In dry climate, for example in the Nordics during winter time, the RH might drop below 30% and in summertime rise above 70%. This will create movements in the floor surface. To secure enough clearance for the natural movements and to avoid possible open joints, squeaking etc. always keep a dilatation joint of 5mm average to walls, thresholds, staircases, pipes etc. during installation. Use the spacers of the installation kit to keep the right clearance. Installing in winter time in very low RH, the clearance to the wall should be lowered to 3mm since the floor panels will shrink, and if installing in high RH climate the clearance should be raised to 8mm since the floor panels will expand. The clearance must be left open and may NOT be filled by any sealant, silicone or other adhesive. Never fasten the floor with nails, glue, screws or in any other way.

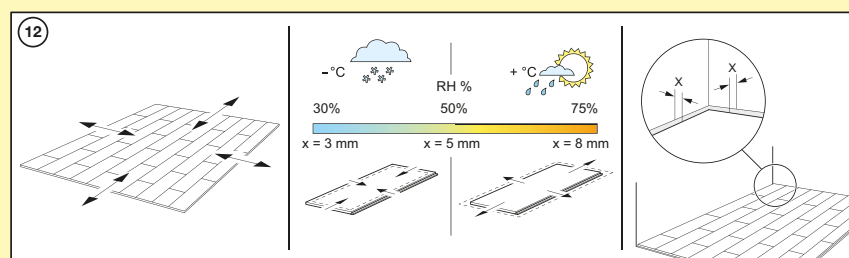

- 13** Due to the fact that all type of wood material by nature will shrink and expand and cope to the changes in relative humidity and temperature we keep as a general rule not to install Pergo laminate in room size more than 13x13 meter. If the surface to cover is bigger, ask the dealer or Pergo technical services about options. It is mandatory to install T-moldings in any doorway. In typical T – L or U – shaped rooms it may also be necessary to install a dilatation joint. Ask for advice in case of doubt.

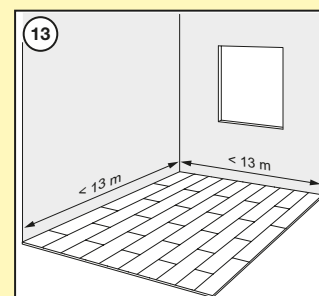

# domestic **Elegance**

## Preparation

- 14 A Pergo 5-in-1 molding is a perfect solution in situations like illustrated. This molding can also take care of transition as well as finishing edges against vertical surfaces such as thresholds, sliding door frames etc. (End molding). When using the 5-in-1 molding, always remember to keep the right dilatation gap between the installed floor and the metal track.

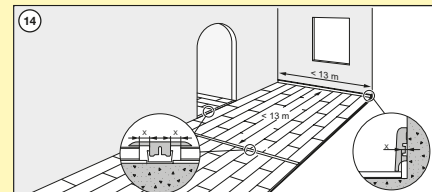

# domestic **Elegance**

## Installation

- 15 Pergo domestic Elegance are easy to install and require no expensive specialty tools. In addition to a few common DIY tools (folding rule, pencil, hammer, handsaw or jigsaw, carpenter's square and possible power drill and working gloves), you only need a Pergo Installation Kit containing a tapping block, pull bar and spacers. Be sure you have all tools available before starting the installation.

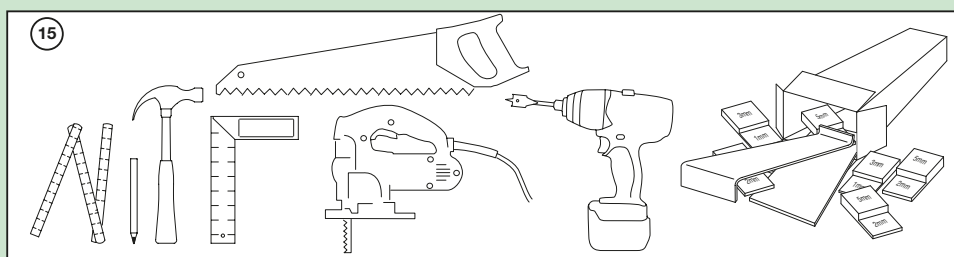

- 16 When cutting the Pergo laminate plank, make sure you are not creating splinters or chipping when cutting. If using a hand saw, keep the decorative surface faced up, and if using a jigsaw keep the decorative surface down.

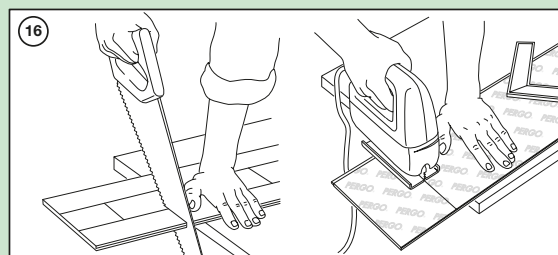

- 17 Every Pergo plank is methodically checked for any imperfections before being packed. Still, packs or planks can be damaged during transportation or when the packs are opened. Do not install a plank with a damaged surface, edge or click joint. Carefully inspect each plank before and during the installation in good light conditions. An installed plank is considered as accepted, and can not be claimed.

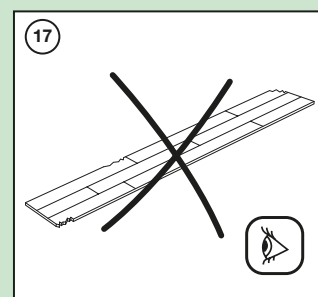

# domestic **Elegance**

## Installation

- 18 Before starting, carefully measure the length and the width of the room to plan a precise layout to achieve a balanced appearance of the floor. This will ensure also you won't end up with the last row being too narrow. If the last row would be less than 40mm, the installation will be easier if you cut down the planks of the first row in the length.

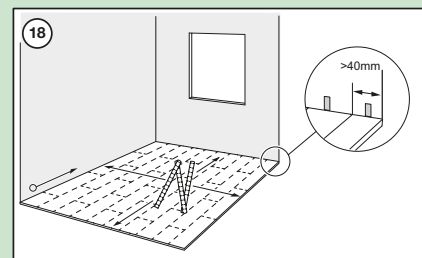

- 19 Often the installation is done parallel to the long walls of the room. The most common direction of installation for all type of laminate floors is to go from left to right, and this information is referring to an installation from left to right. The planks should be installed facing the tongue side (A) to the wall. Always remember the spacers.

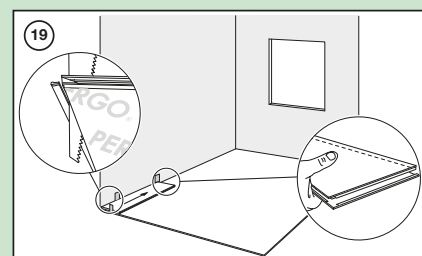

# domestic **Elegance**

## Installation

- 20** Narrow down the width of the planks of the first row (ref. illustration no. 18 and 19) or as a minimum cut off the tongue to achieve the right distance to the wall. If the wall is curved/uneven, the first row has to be cut and coped to the contour off the wall. Use spacers! The first plank in the row should now have the profile "B" to the right. The easiest way to connect the plank ends together is by a rotating fold down movement. You can tap the joint gently together using the Pergo tapping block and a hammer.

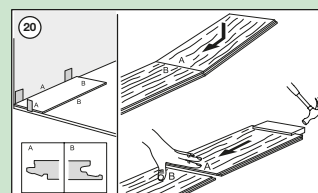

- 21** The easiest way to connect the planks is by a rotating movement. Install the first plank in the second row by rotating it in on the long side to the first row. Rotate in the second plank in the end of the first plank, and angle up the two planks in about 20 degrees and rotate in the long joint. You can tap the long joint together keeping the planks in a flat position using the tapping block and a hammer.

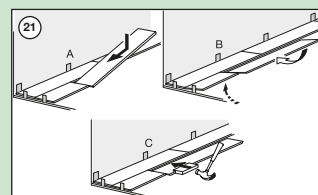

- 22** Install the first 2 rows in accordance to the illustration. We recommend the overlap/staggering between end joints to be about 1/3 of the plank length, but never less than 300mm. Installing the 2 first rows like shown will help out to keep a straight edge to start the rest of the installation. The cut off from the first and second row should normally be perfect as starting planks in the third and fourth row. Always remember using the spacers to keep the right distance to walls etc.

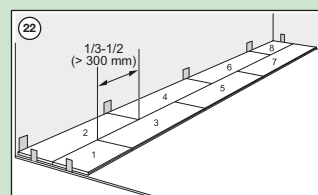

- 23** For a nice finish where the new flooring meets a threshold, we recommend undercutting the moldings of the door. To secure the right cut off, turn a Pergo plank upside down and place it on the floor up to the door frame. Then, place the hand saw flat against the plank and simply cut through the frame/molding as shown. Remove the cut out and vacuum away debris. You can then simply slide the floor underneath the frame/molding and make a perfect finish.

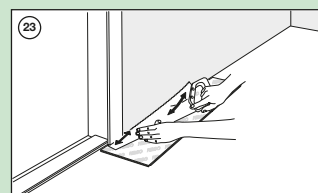



# domestic **Elegance**

## Installation

- 24** For the final row, cut the planks in the proper width remembering to leave the recommended expansion space and making necessary adjustments to follow the contour of the wall. If there is a doorway in this wall, click the plank in on the long side at the side of the undercut molding, slide/tap the plank underneath and tap the end together using the Pergo tapping block. Control the tightness in the joint, and use the pull bar to secure absolute tightness in the long joint.

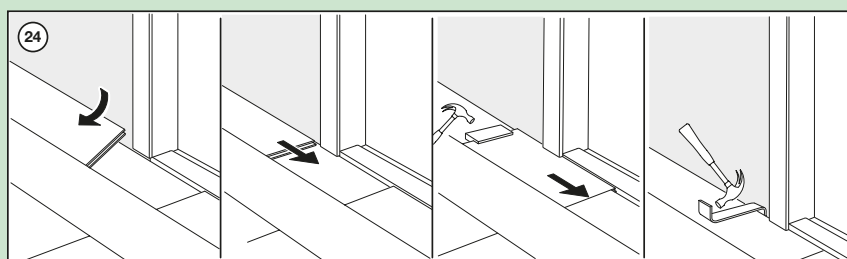

- 25** To install Pergo laminate flooring around pipes, carefully measure and mark the planks with the exact centre point for each pipe. Drill a hole at each of the marked points that is equivalent to the diameter of the pipe + 16mm. If located on the long side of the plank, make a 45 degree cut from each hole to the edge of the plank, and then cut between the holes as shown. If located on the end of a plank, make a straight cut across the plank. Install the plank. Then, using Pergo SafeSeal or regular wood glue along the cut edges of the piece you cut out, glue the piece in place where it belongs. Be sure no glue comes between the cut out piece and the subfloor. Use spacers to secure a tight glue joint, and remove any glue or SafeSeal on the floor surface directly with a damp cloth. The gap you have created between the pipes are to ensure the floor can move as expected from season from season, and are not to be filled with any sealant, silicone or other adhesive. Use Pergo radiator caps to conceal gaps around radiator pipes.

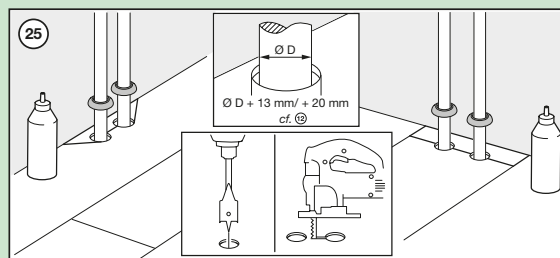

- 26** Inspect the final surface of the installed floor, remove all spacers and install Pergo wall bases according to the instructions following the wall bases.

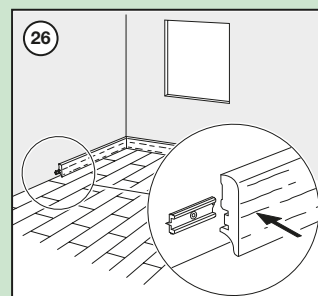

# domestic **Elegance**

## Cleaning Instructions

- 27 After installation, vacuum using a vacuum head with soft edges. Dry mop or sweep the floor to remove dirt and dust. Wipe the floor with hand warm water containing one or two “bottle caps” of Pergo all-round cleaner and using Pergo micro fiber mop. The daily cleaning should follow the instructions on the Pergo web. site. The use of inappropriate cleaning products might damage the flooring surface!
- 28



- 29 Castor chairs must have castors of the so called “Soft wheels”.

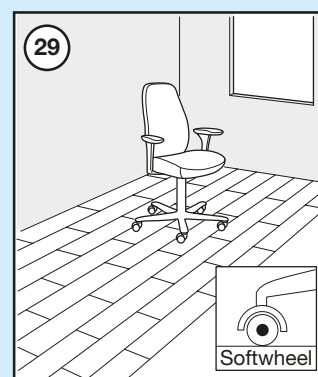

## domestic **Elegance**

### Cleaning Instructions

- 30 All furniture legs should be protected with felt pads to avoid scratching the finished surface. Avoid sliding heavy furniture etc. over the Pergo floor to avoid possible scratching. Lifting the furniture is recommended. Always place a quality door mat at any entrance door to avoid introduction of sand and dirt which might create scratches.

